

GOLF EDGE

EMAAR SOUTH

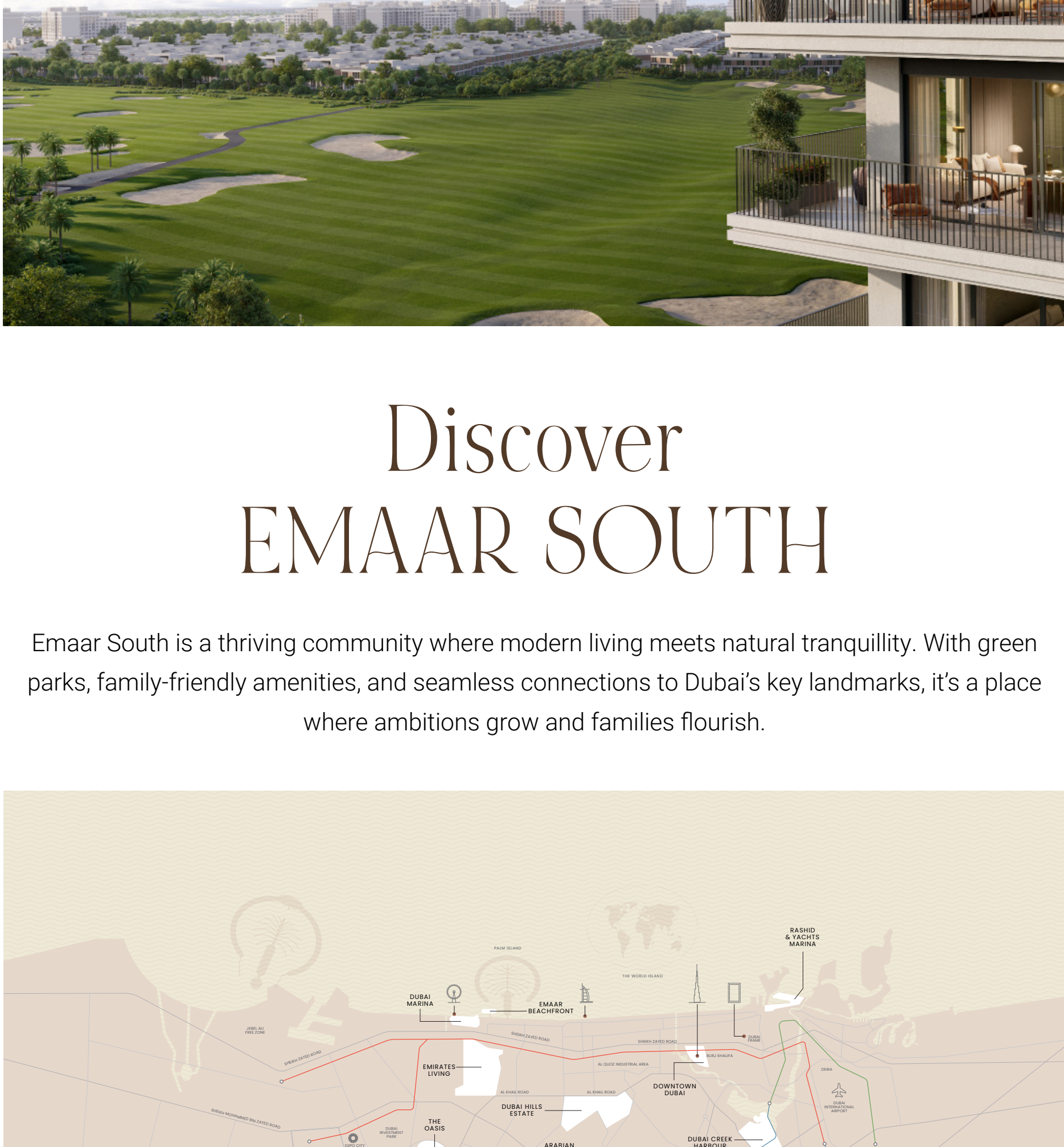

Discover EMAAR SOUTH

Emaar South is a thriving community where modern living meets natural tranquility. With green parks, family-friendly amenities, and seamless connections to Dubai's key landmarks, it's a place where ambitions grow and families flourish.



A Serene Escape with Endless Possibilities

Step into a retreat that exudes the calm of an exclusive sanctuary. Surrounded by green hills, lush fairways, and golf courses, each home at Golf Edge blends naturally with its surroundings.

It isn't just a home—it's where aspirations flourish, and possibilities are limitless.



Living Made Simple

Discover homes thoughtfully designed to meet diverse lifestyles, offering 1 to 3-bedroom apartments and exclusive 3-bedroom townhouses, all crafted for tranquil, golf-inspired living.



Residential Units

No. of Bedrooms	Units	Min. BUA (sq. ft.)	Max. BUA (sq. ft.)	Starting Price (in AED Mn) From
1-Bedroom	95	796	967	1.17 Mn
2-Bedroom	58	1,181	1,409	1.73 Mn
3-Bedroom	26	1,641	2,987	2.50 Mn
3-Bedroom Townhouse	5	2,965	2,987	4.75 Mn



Payment Plan

Instalment	Payment Percentage	Date
Down Payment	10%	Jan 2025
1st Instalment	10%	Mar 2025
2nd Instalment	10%	Aug 2025
3rd Instalment	10%	Jan 2026
4th Instalment 20% Construction Completion	10%	Sep 2026
5th Instalment 40% Construction Completion	10%	Feb 2027
6th Instalment 60% Construction Completion	10%	Aug 2027
7th Instalment 80% Construction Completion	10%	Jan 2028
8th Instalment 100% Construction Completion	20%	Feb 2029

Live, Play & Thrive by the Greens

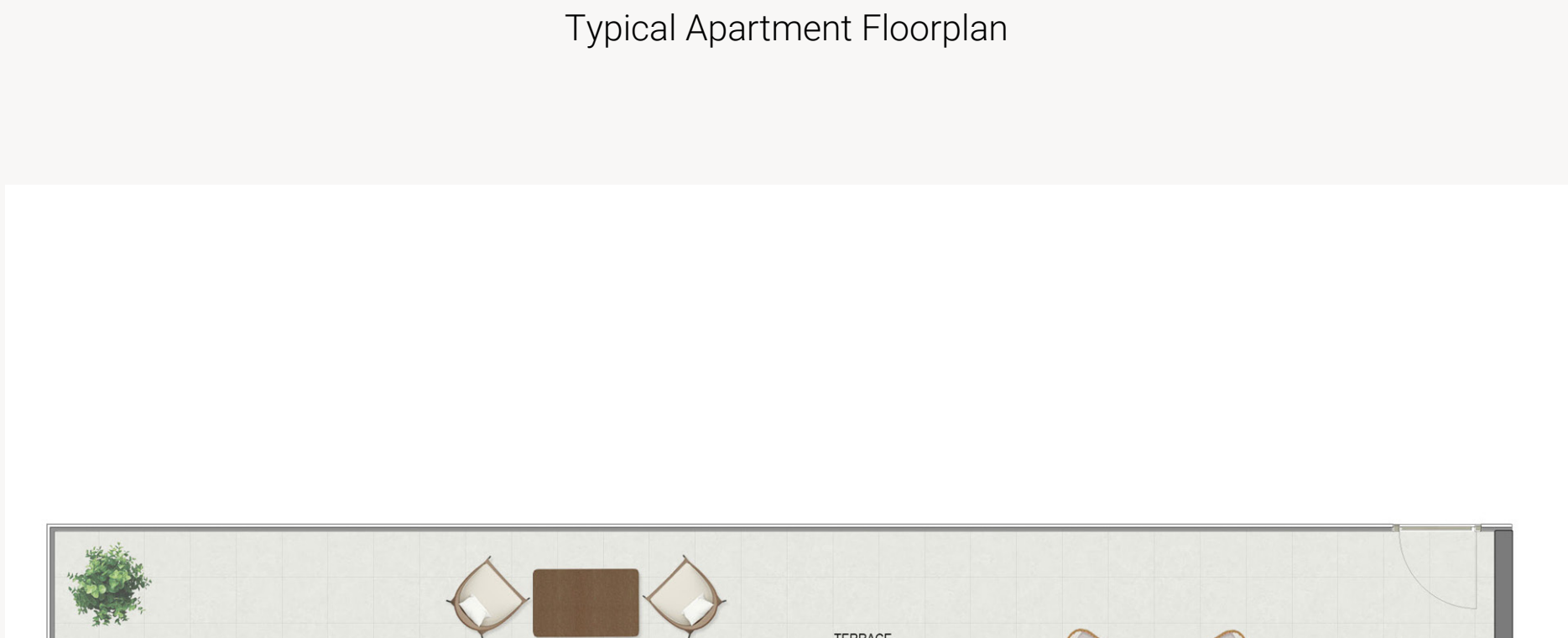

Lush gardens and pool

Yoga deck and outdoor gym



Kids' play area and jogging track

Barbeque spaces with panoramic views

1-Bedroom

Typical Apartment Floorplan

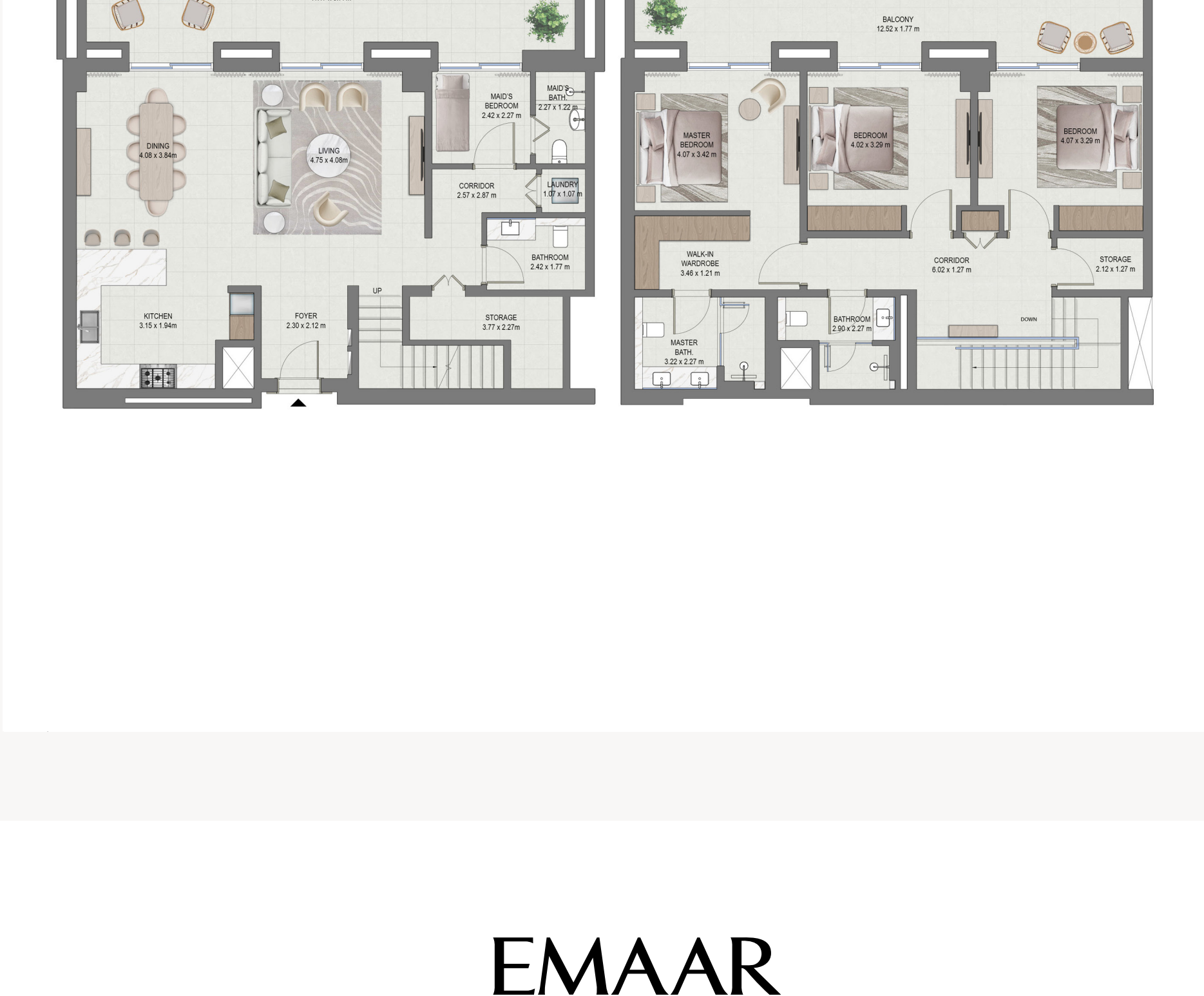

2-Bedroom

Typical Apartment Floorplan

3-Bedroom

Typical Apartment Floorplan

3-Bedroom

Typical Townhouse Floorplan

