

VELOS

PACE WITH PURPOSE



Rooted in
Motor City
built for connection

VELOS





A life of limitless energy and infinite possibility

Velos, developed by CITYVIEW URBAN, is for people who enjoy living life with purpose and pace. A dynamic destination, it draws inspiration and energy from its location in Motor City.

Building Structure: G + 2P + 30 Floors + Roof

Unit Type	Number of Units	Size Range (sq.ft.)	Specifications
Studios	144	341-489	Fully-Furnished
1 Bedroom	208	668-898	Unfurnished but includes Kitchen Appliances
2 Bedroom	56	989-1,235	
Retail	4	1,470-3,224	

Life flows
effortlessly





Welcome to
Dubai's
most dynamic
city district

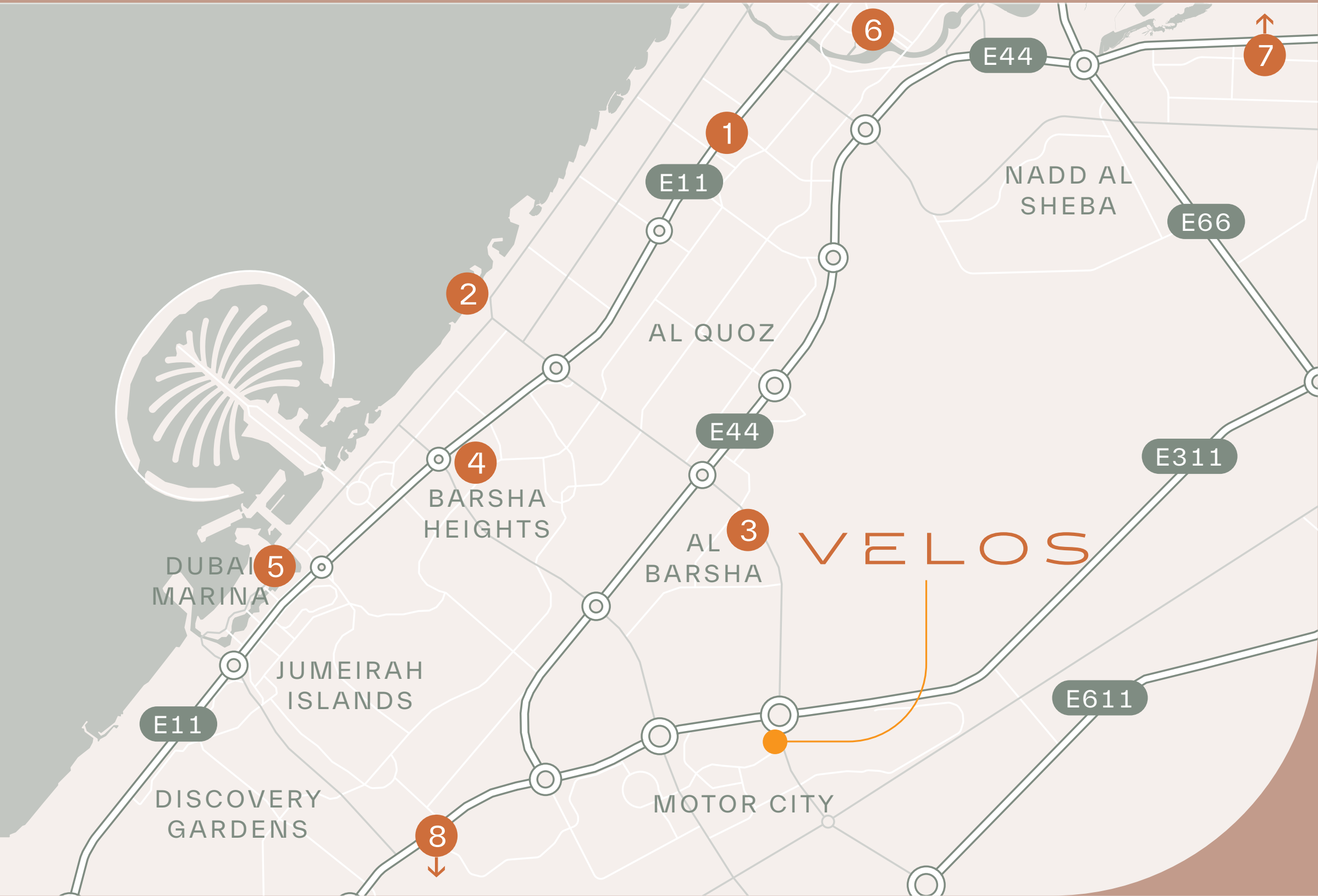

Within Dubai's most dynamic city district, Velos is the new focal point for everything vital and vibrant.

- Sheikh Zayed road — 15 mins 1
- Burj Al Arab — 20 mins 2
- Dubai Hills Mall — 10 mins 3
- Mall of the Emirates — 15 mins 4
- Dubai Marina — 22 mins 5
- Burj Khalifa — 24 mins 6
- DXB International Airport — 28 mins 7
- Al Maktoum Int'l Airport — 26 mins 8



Connecting everyone to everything that matters

Conveniently located a short drive away from Burj Khalifa and Sheikh Zayed Road, placing you at the core of Dubai with seamless access to all attractions the city has to offer.

Step into the Velos Lobby

Elegant, welcoming, and
thoughtfully designed.

Studio

Turnkey, furnished studios designed for modern living.







1 Bedroom

Thoughtfully designed 1-bedroom units, combining modern comfort with elegant, functional living spaces.











2 Bedroom

2 bedroom apartments with exceptional views and superior comfort.















Discover wellness at the core of City Life

Velos amenities are carefully designed and considered to provide residents with an invigorating and rejuvenating experience. It's a world of working out and wellness that provides everything you need.





- Outdoor Gym
- Indoor Gym & Yoga Area
- Rooftop Infinity Pool & Wooden Deck
- Outdoor Kids' Pool & Play Area
- Indoor Kids' Play Area
- Outdoor Yoga Area
- Outdoor Cinema
- Jogging Track
- Basketball Half Court
- Padel Court
- Green Areas
- Sky Garden Meditating Area
- Mediterranean Themed Garden
- Japanese Zen Garden
- Pet Area
- Lounge Area
- Beverages Bar
- Coworking Zone
- Sitting Area
- Multi-Purpose Area

Unwind at the Rooftop Infinity Pool & Wooden Deck

Dip into the Outdoor
Swimming Pool

Refresh and relax
at the Beverages Bar



Take a stroll through
the lush Green Areas





Stretch in the
Outdoor Yoga Area

Find harmony in the Japanese Zen Garden

Shoot and score
at the Basketball Half Court

Stay active on the
community Jogging Track

Catch a film under the stars
at the Outdoor Cinema



Host or gather
in the Multi-Purpose Area





Pause and reflect in the Sitting Area

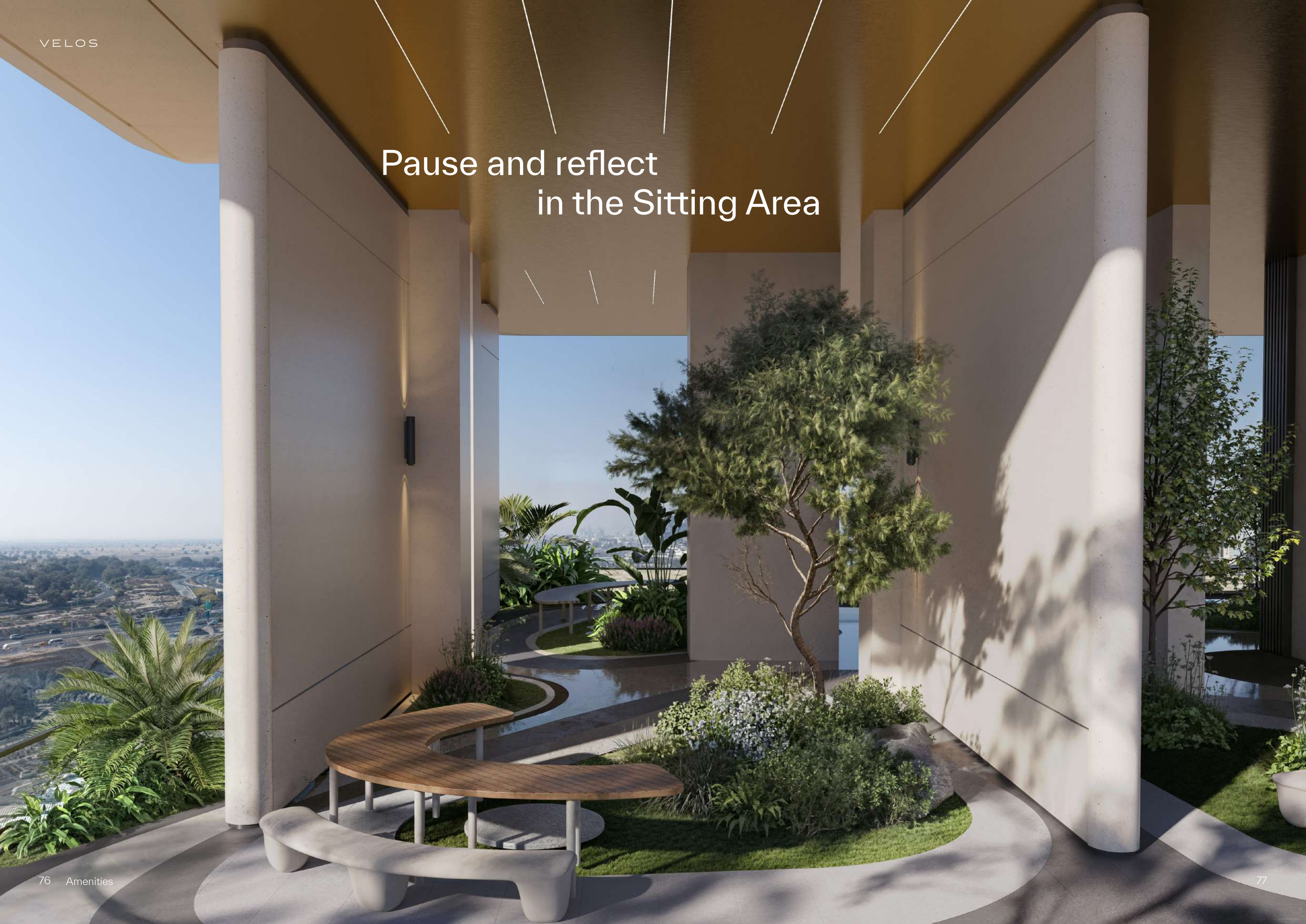



Stay productive in the
Co-Working Zone

Break a sweat in the Indoor Gym



The Outdoor Kids' Play Area brings fun to little ones



Let imaginations run wild
in the Indoor Kids' Play Area

The Outdoor Pet Area provides
a fun space for your furry friend



Specifications

GENERAL

- Porcelain tile with wood-look effect for flooring
- Off white paint for walls and ceiling
- Curtain pelmets with recessed LED strips
- Modern design stainless steel finish switches and power socket
- Floor to ceiling windows with outdoor views
- Chandelier provisions at center of main areas
- Porcelain tile with wood-look effect for skirting

KITCHENS

- Full suite of integrated appliances
- Natural oak and matt plain laminate cabinetry
- Quartz stone with terrazzo finish countertop and backsplash

BEDROOMS

- Closed wardrobe with plain matt laminate finish

BATHROOMS

- Built-in mirrors with integrated LED strips
- Quartz stone top with terrazzo effect on vanity with minimal integrated sink design
- Mosaic terrazzo effect on vanity backsplash
- Natural oak wood for storage cabinetry under vanity and above WC area
- Travertine look porcelain tile on shower walls
- Cement look porcelain tile on floor & walls
- Walk-in shower with floor to ceiling glazing with metal frame
- Chrome metal finish to bathroom fixtures





CITYVIEW URBAN is a UAE-based real estate developer with a global presence, renowned for its fresh and creative approach to residential, commercial, and hospitality spaces.

Through strategic collaborations with top global brands and award-winning architects, CITYVIEW creates dynamic developments that are strategically located and crafted to inspire, connect, and evolve with the changing needs of modern urban life. CITYVIEW is best known for developing Hyde Residences Dubai Hills, the first lifestyle branded development in Dubai Hills Estate.

WWW.CITYVIEW.ME
FOLLOW @CITYVIEW_UAE

VELOS